

SITE LOCATION



ADDITIONAL SIGNAGE WHERE REQUIRED BELOW

- Site Access/Egress
 - Uneven Surface
 - Slippery Surface
 - Overhead Cables
- During darkness at unit areas following a site risk assessment additional lighting to be installed

- LEGEND:**
- DIVERSION ROUTES
 - PEDESTRIAN ROUTE
 - WORKPLANT AREA
 - SAFETY AREA
 - LATERAL SAFETY ZONE
 - PEDESTRIAN BARRIER
 - SITE BARRIER
 - CONES
 - SIGN LOCATION & ORIENTATION
 - BARRIER BOARD

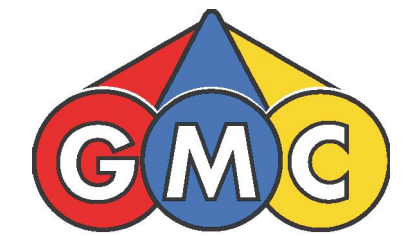

GMC Utilities Group Ltd, GMC House,
Millenium Business Park, Cappagh Road,
Ballycoolin, Dublin 11, Ireland.
Tel: +353 (0)1 864 9800
Email: info@gmcirl.com

Project ;	46315422 Gas Networks Ireland
Location ;	Stepaside Lane Enniskerry Road Junction R117 Kilgobbin Dublin
TM Method ;	Road Closure / Diversion
Designer ; DG	Drawn ; DG Approved ; DG
Date ;	20/11/2023
Layout ;	SITE LAYOUT
TMP Guide Reference ;	TMP-001
Dwg Number ;	GMC-TMP-16363-REV00

NORTHBOUND TRAFFIC DIVERSION

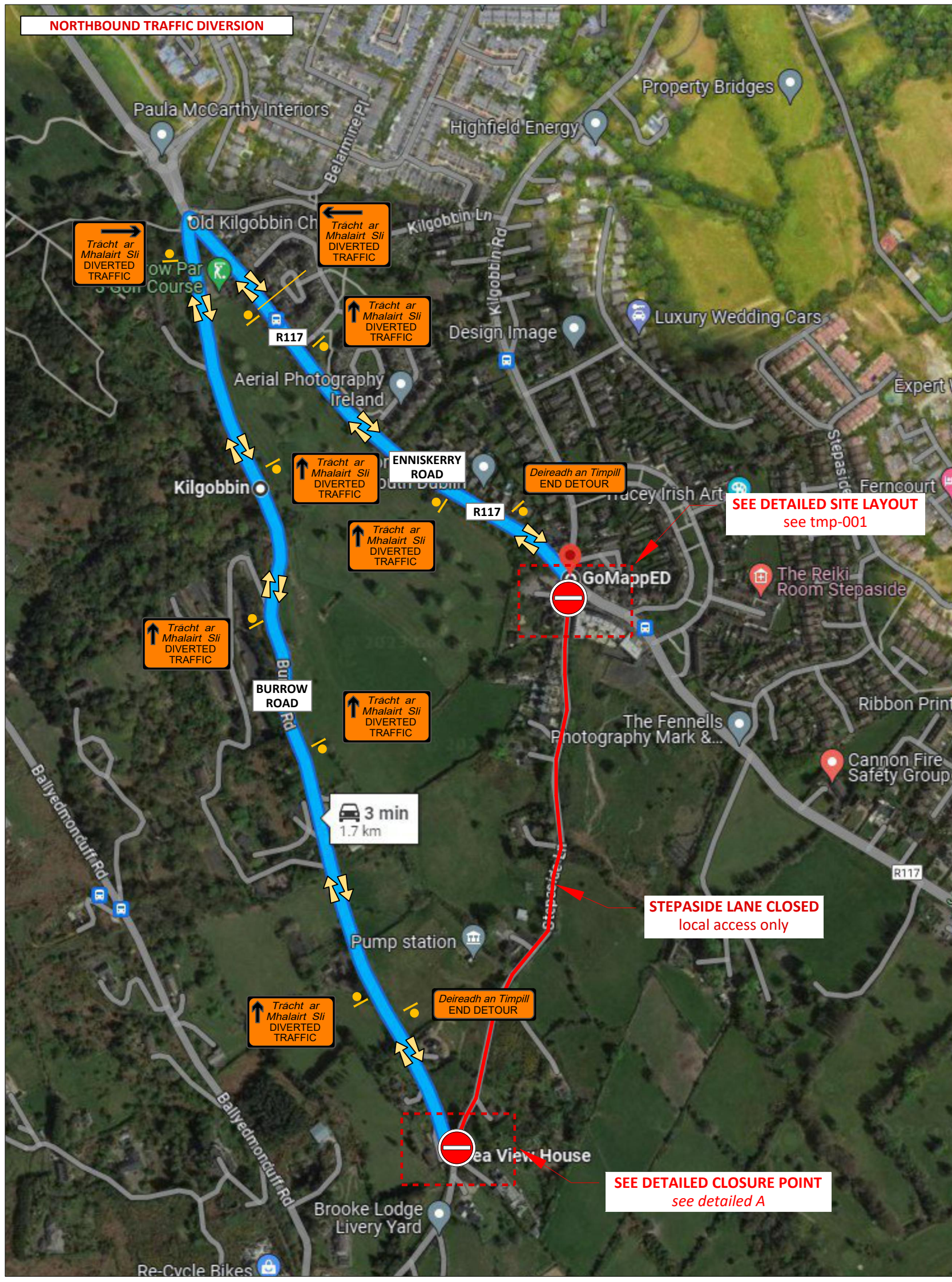

DETAILED A CLOSURE POINT

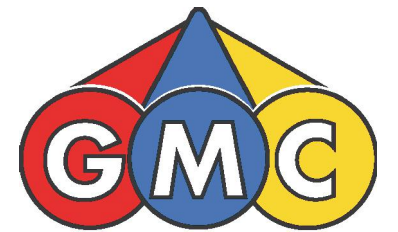
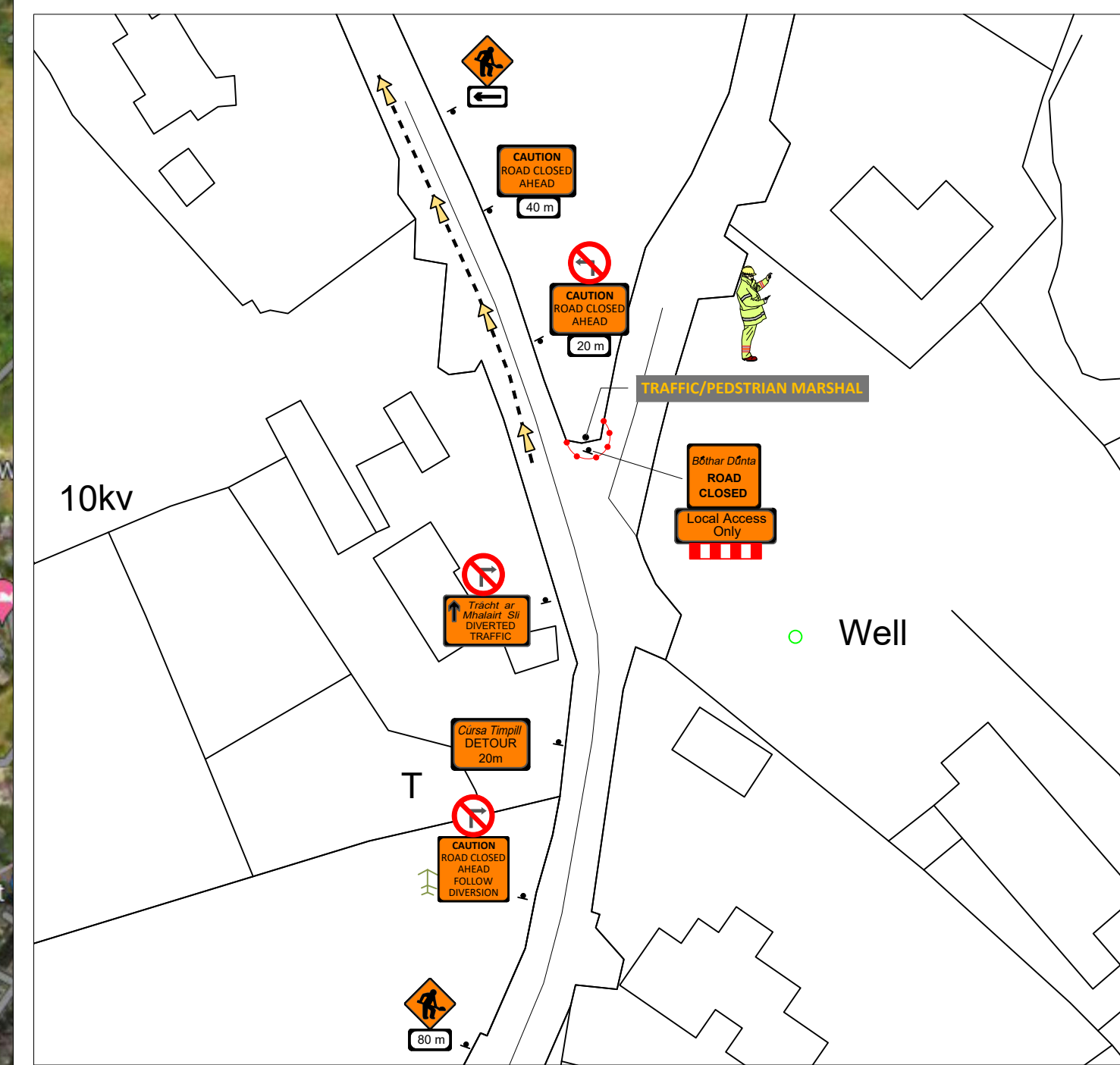

GMC Utilities Group Ltd, GMC House,
Millenium Business Park, Cappagh Road,
Ballycoolin, Dublin 11, Ireland.
Tel: +353 (0)1 864 9800
Email: info@gmcirl.com

Project ;	46315422 Gas Networks Ireland
Location ;	Stepaside Lane Enniskerry Road Junction R117 Kilgobbin Dublin
TM Method ;	Road Closure / Diversion
Designer ; DG	Drawn ; DG
Approved ; DG	
Date ;	20/11/2023
Layout ;	DIVERSION ROUTE A
TMP Guide Reference ;	TMP-002
Dwg Number ;	GMC-TMP-16364-REV00

SOUTHBOUND TRAFFIC DIVERSION

SEE DETAILED SITE LAYOUT
see tmp-001

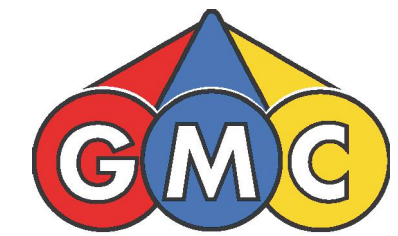
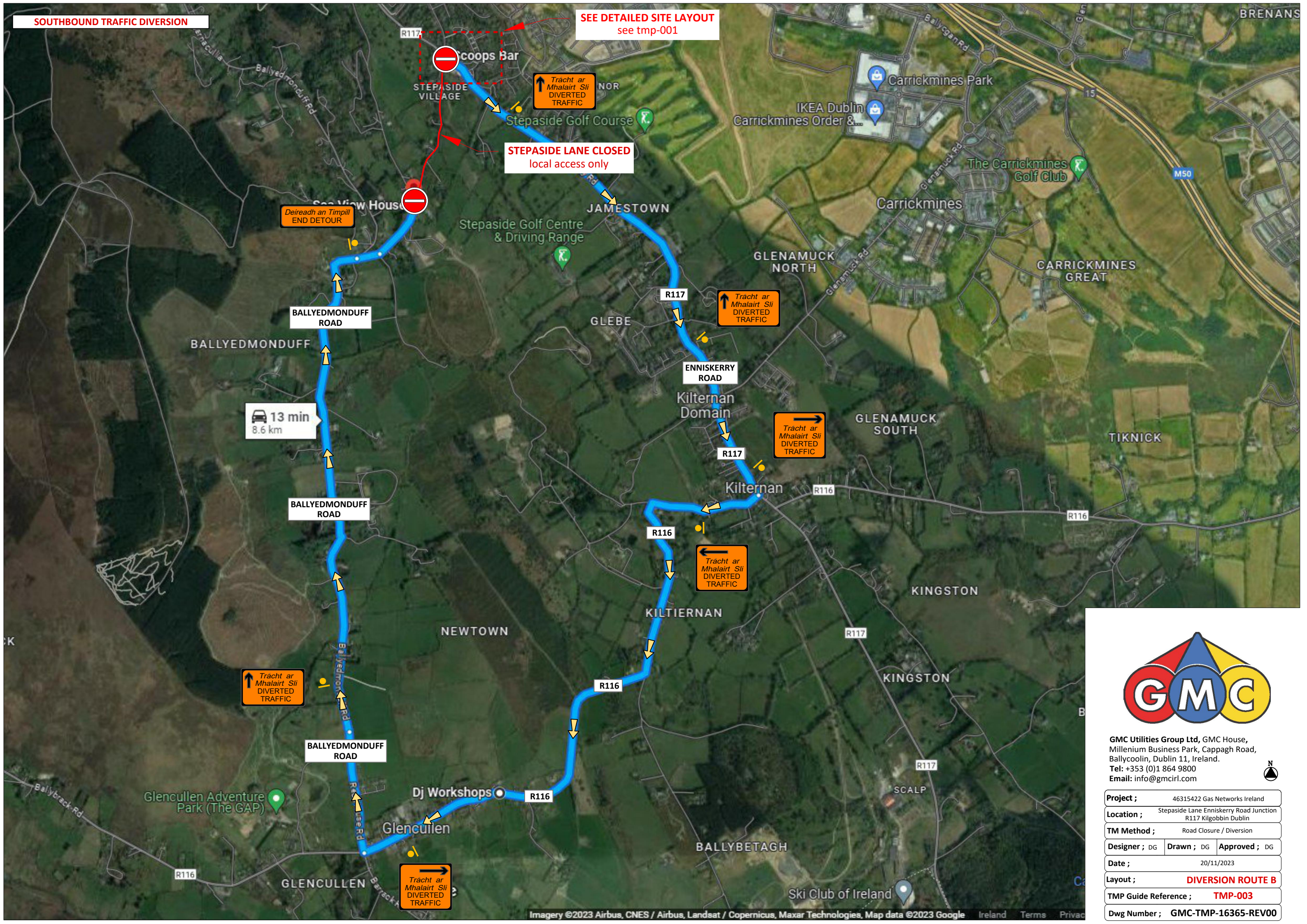

GMC Utilities Group Ltd, GMC House,
Millenium Business Park, Cappagh Road,
Ballycoolin, Dublin 11, Ireland.
Tel: +353 (0)1 864 9800
Email: info@gmcirl.com

Project ;	46315422 Gas Networks Ireland
Location ;	Stepaside Lane Enniskerry Road Junction R117 Kilgobbin Dublin
TM Method ;	Road Closure / Diversion
Designer ; DG	Drawn ; DG Approved ; DG
Date ;	20/11/2023
Layout ;	DIVERSION ROUTE B
TMP Guide Reference ;	TMP-003
Dwg Number ;	GMC-TMP-16365-REV00