

Cherrywood to Rathmichael Manor Rapid Build Cycle Scheme

Works will be undertaken under Section 38 of
the Road Traffic Act 1994 (as amended)



APRIL 2024

Scheme Overview

Dún Laoghaire-Rathdown County Council (DLRCC), in conjunction with the National Transport Authority (NTA) are working with ARUP consulting engineers on the *Cherrywood to Rathmichael Manor Rapid Build Cycle Scheme*.

The proposed *Cherrywood to Rathmichael Manor Rapid Build Cycle Scheme* is being promoted by the Active Travel Section, Infrastructure and Climate Change Department with the objective of promoting cycling as a mode of transport, through the provision of improved cycling infrastructure and routes to schools, health services, employment and recreation facilities.

THE PURPOSE OF THIS NON-STATUTORY PUBLIC CONSULTATION IS TO INFORM THE PUBLIC OF THE PROPOSED WORKS AND INVITE SUBMISSIONS.



Scheme Location

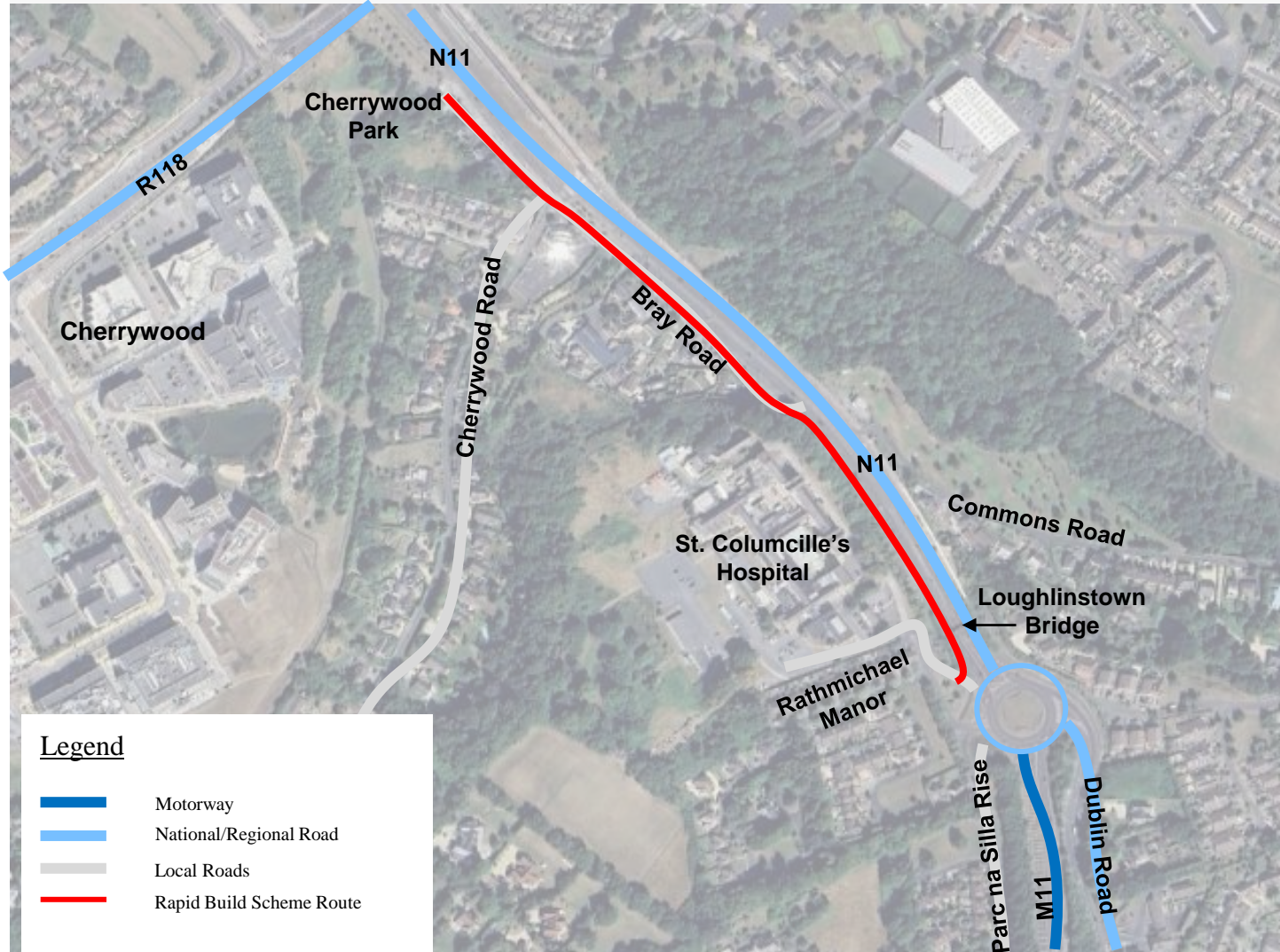

Rapid Build Cycle
Scheme proposed
along the Bray Road,
between Cherrywood
Park access and
Rathmichael Manor.

Scheme Phases

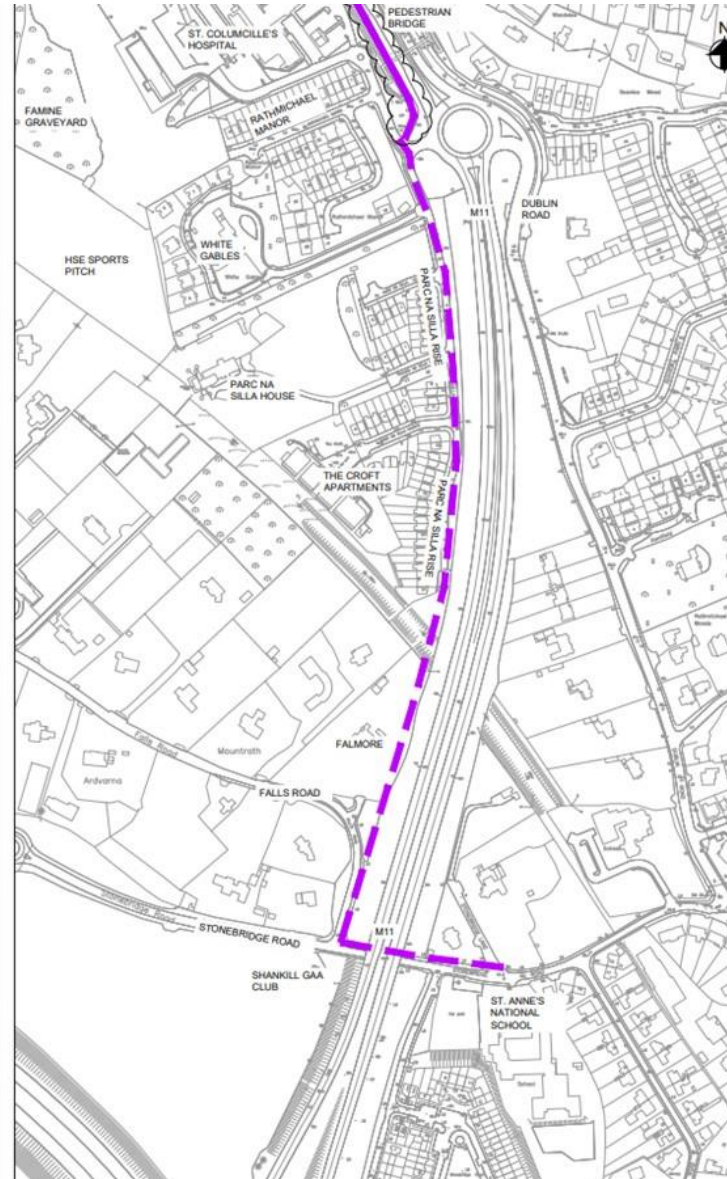
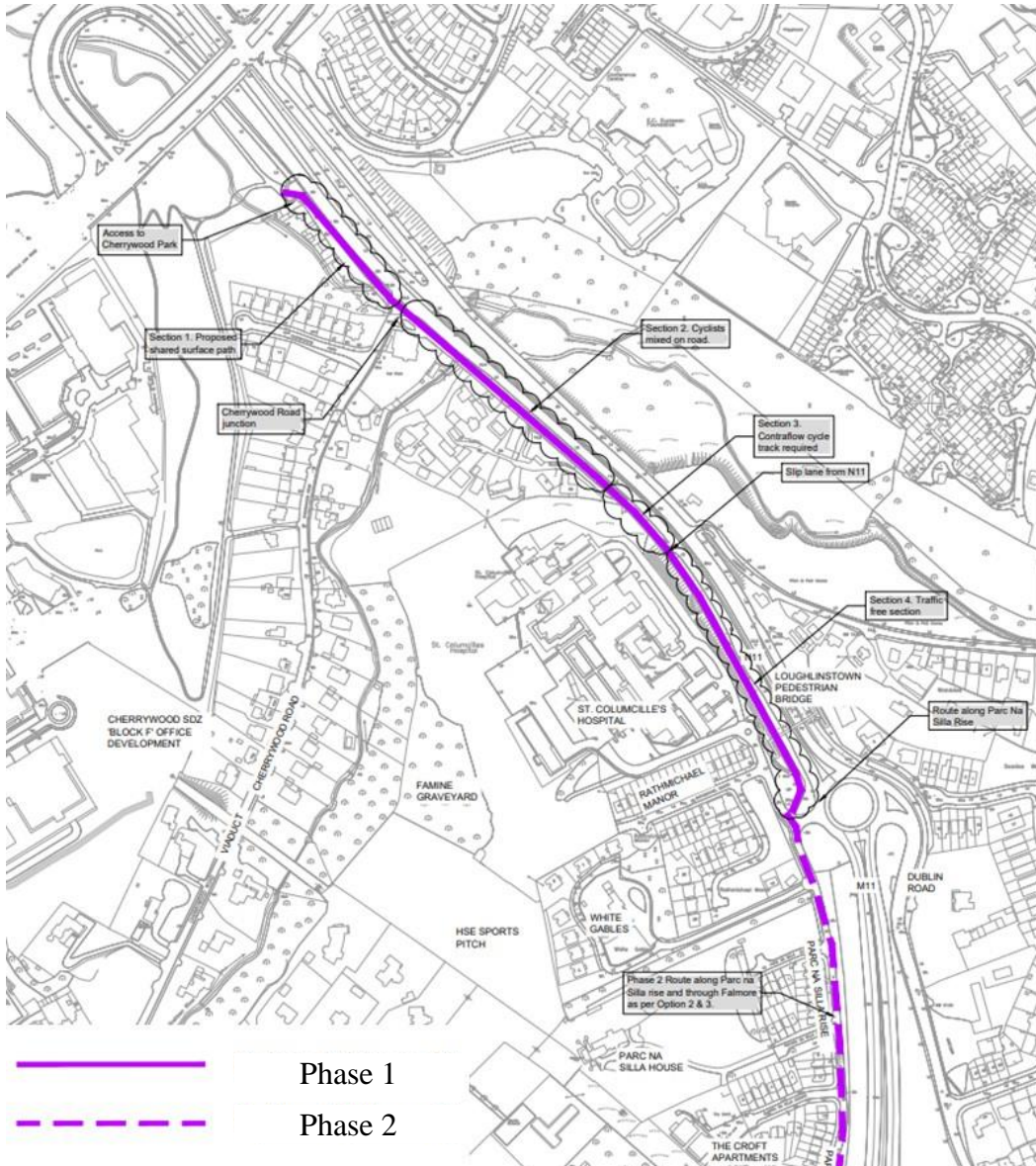

- **PHASE 1 – Rapid Build Scheme** between Cherrywood Park access and Rathmichael Manor, mainly along Bray Road
- **PHASE 2 – Future extension of scheme** along Parc na Silla Rise and through lands at to connect with Falls Road and Stonebridge Road

The proposed *Cherrywood to Rathmichael Manor Rapid Build Cycle Scheme* comprises Phase 1 only.

What is the *Cherrywood to Rathmichael Manor Rapid Build Cycle Scheme*?

- Scheme is approximately 720 metres in length with no works outside the existing carriageway verge and footpath.
- Route starts at Cherrywood Park access, routing along the Bray Road on the western side of the N11 as far as Rathmichael Manor.
- Access will be maintained to all existing properties along the route.
- A 'cycle street' design is proposed along the Bray Road (slip road from N11). The 'cycle street' transitions into a shared path for a short distance as the Bray Road slip lane merges onto the new 'cycle street'.
- Upgrade existing footpath between the N11/Bray Road slip road and Rathmichael Manor to a two-way cycle track and footpath and a shared path linking to the Loughlinstown pedestrian bridge.
- Upgrade to an island style bus stop (St Columcille's Hospital, stop 3143).
- New pedestrian crossing and cycle crossing at Rathmichael Manor.
- Additional traffic calming measures including new road markings, signage and two raised tables along the Bray Road.



Examples of Cycle Streets



© Cycle Design Manual



© IrishCycle.com

CHERRYWOOD TO RATHMICHAEL MANOR RAPID BUILD CYCLE SCHEME VISUALISATIONS

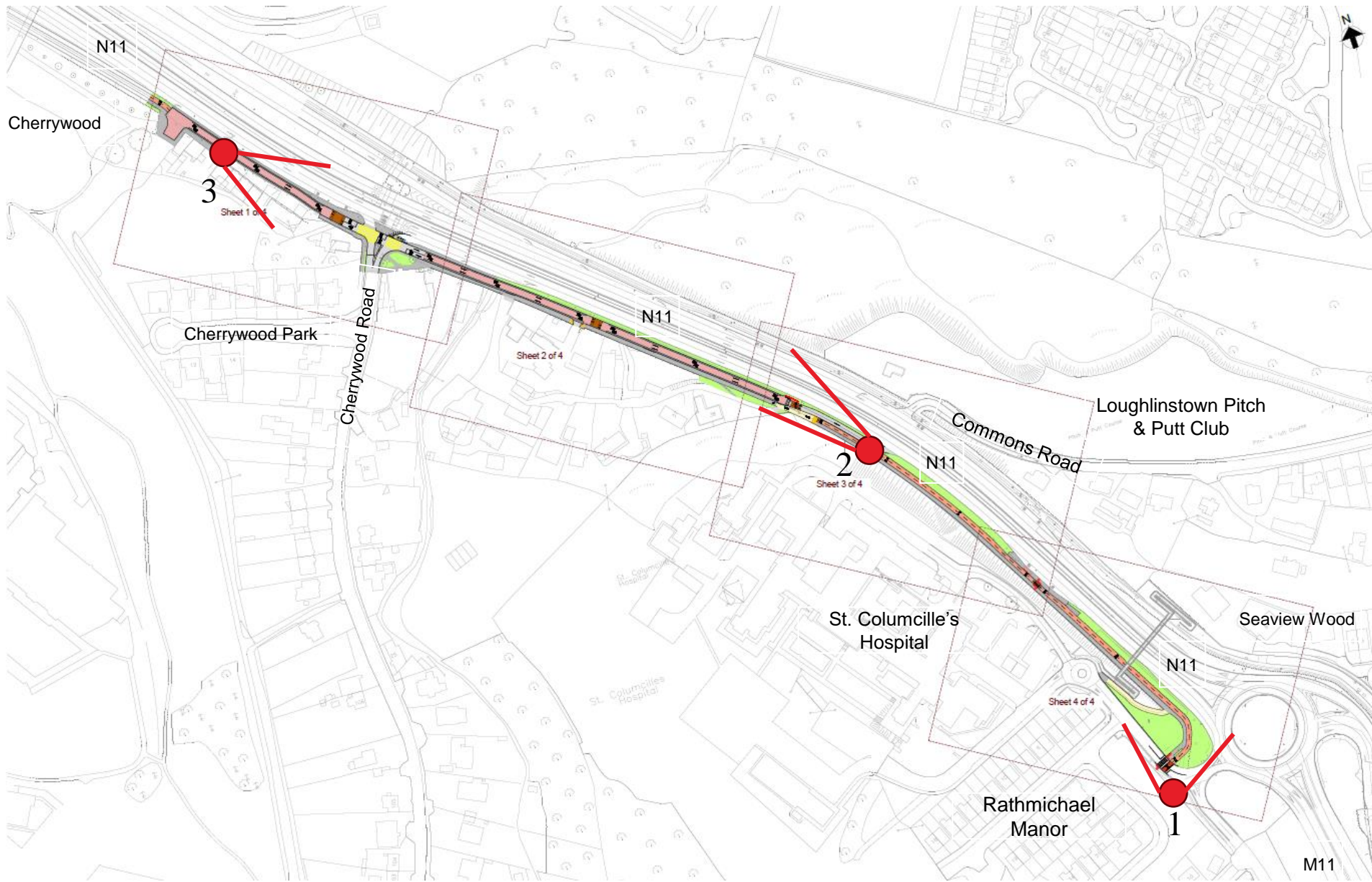

Location of visualisation viewpoints Nos. 1-3

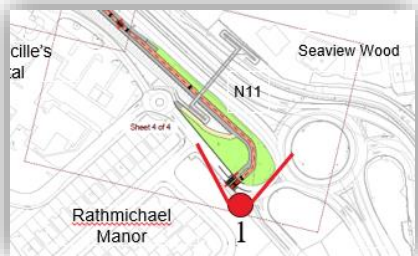

VIEW 1: RATHMICHAEL MANOR

Before & After Perspective

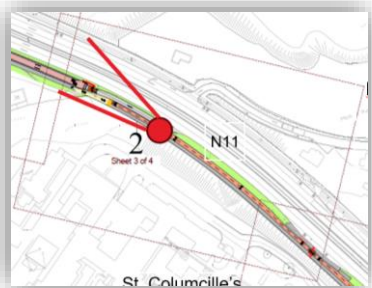

VIEW 2: BRAY ROAD
Before & After Perspective

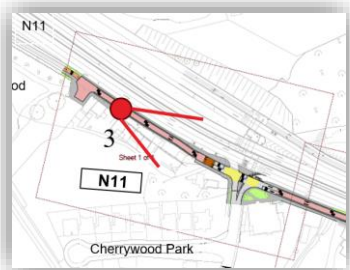

VIEW 3: BRAY ROAD (NEAR BEST DRIVE)

Before & After Perspective

Route Overview

Cherrywood Park access to Rathmichael Manor

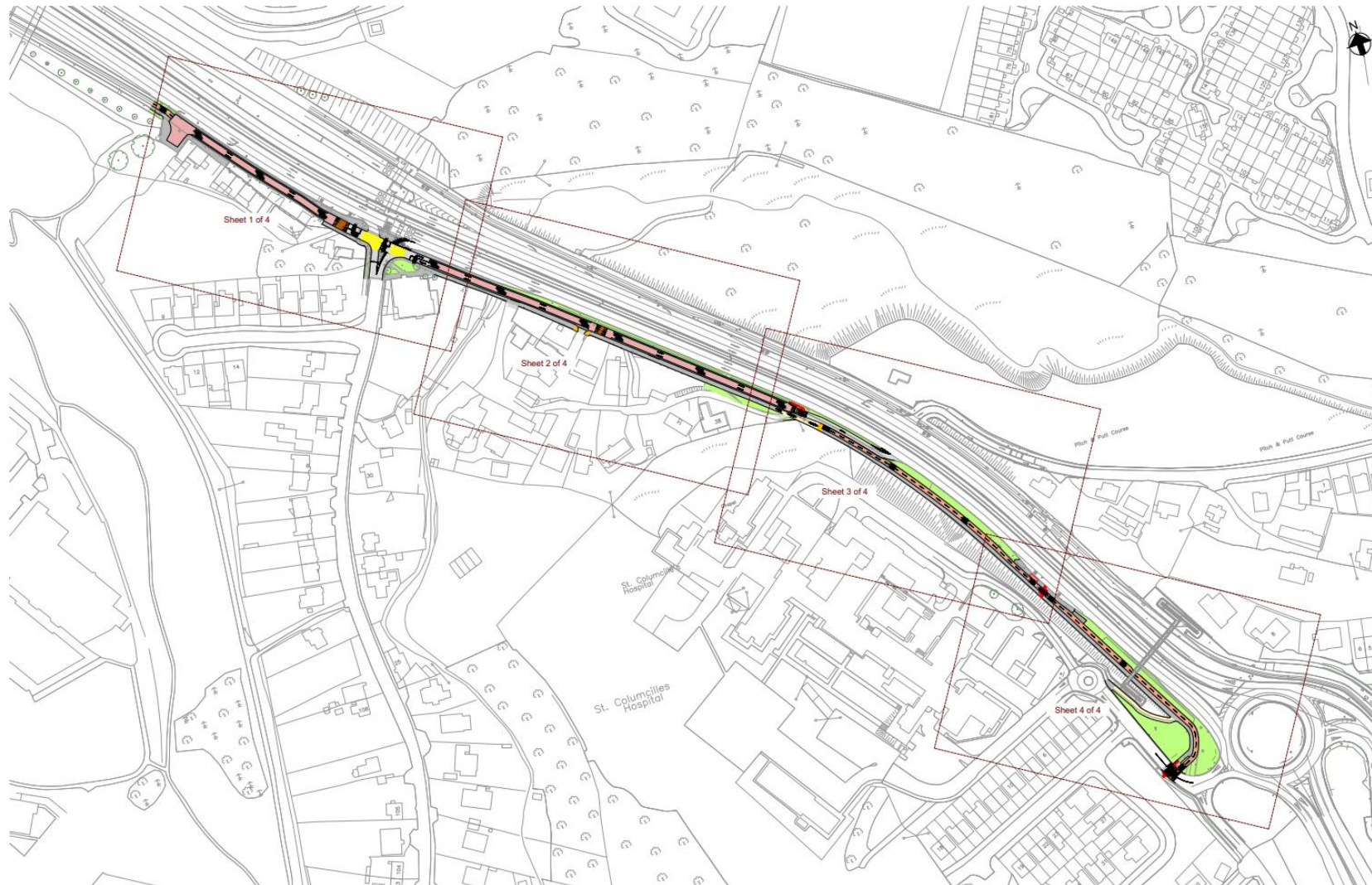

- The route commences at the Cherrywood Park access, routing along the Bray Road on the western side of the N11 as far as Loughlinstown Pedestrian Bridge.
- Along Bray Road, a 'cycle street' design is proposed which utilises the low-traffic nature of the Bray Road.
- South of N11/Bray Road slip lane access, a two-way cycle track and footpath provided.
- New pedestrian and cycle crossing at Rathmichael Manor.

Section 1

Cherrywood Park access to south of Cherrywood Road junction

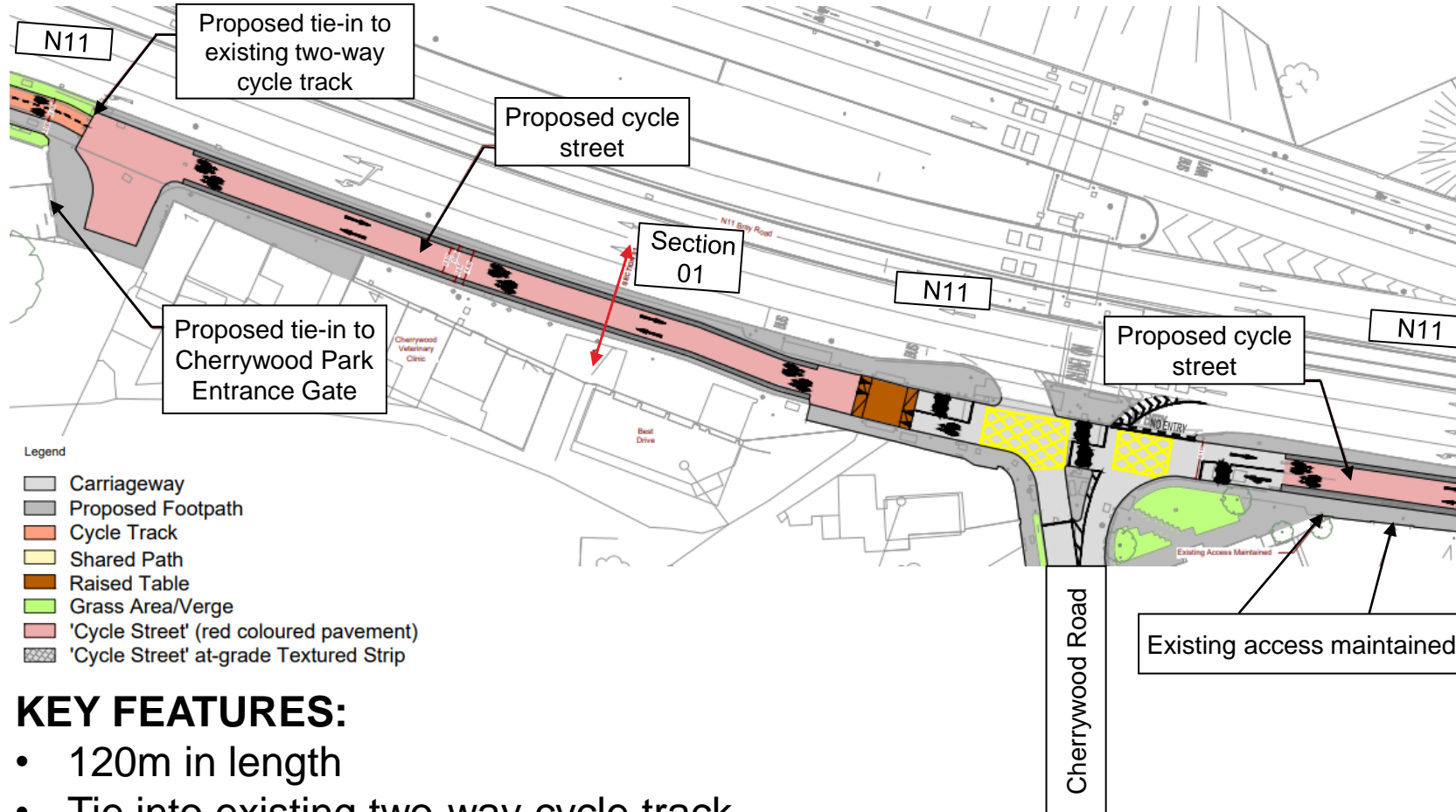

- Legend
- Carriageway
 - Proposed Footpath
 - Cycle Track
 - Shared Path
 - Raised Table
 - Grass Area/Verge
 - 'Cycle Street' (red coloured pavement)
 - 'Cycle Street' at-grade Textured Strip

KEY FEATURES:

- 120m in length
- Tie into existing two-way cycle track
- Cycle Street
- Access maintained to existing properties

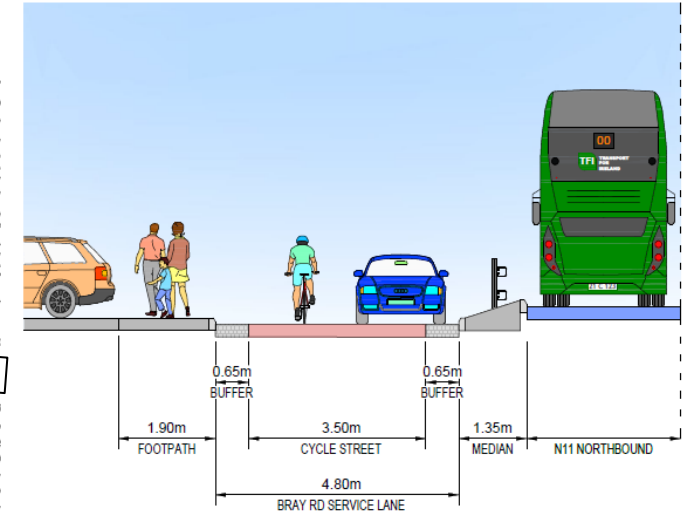

Cross Section 01

Section 2

Bray Road

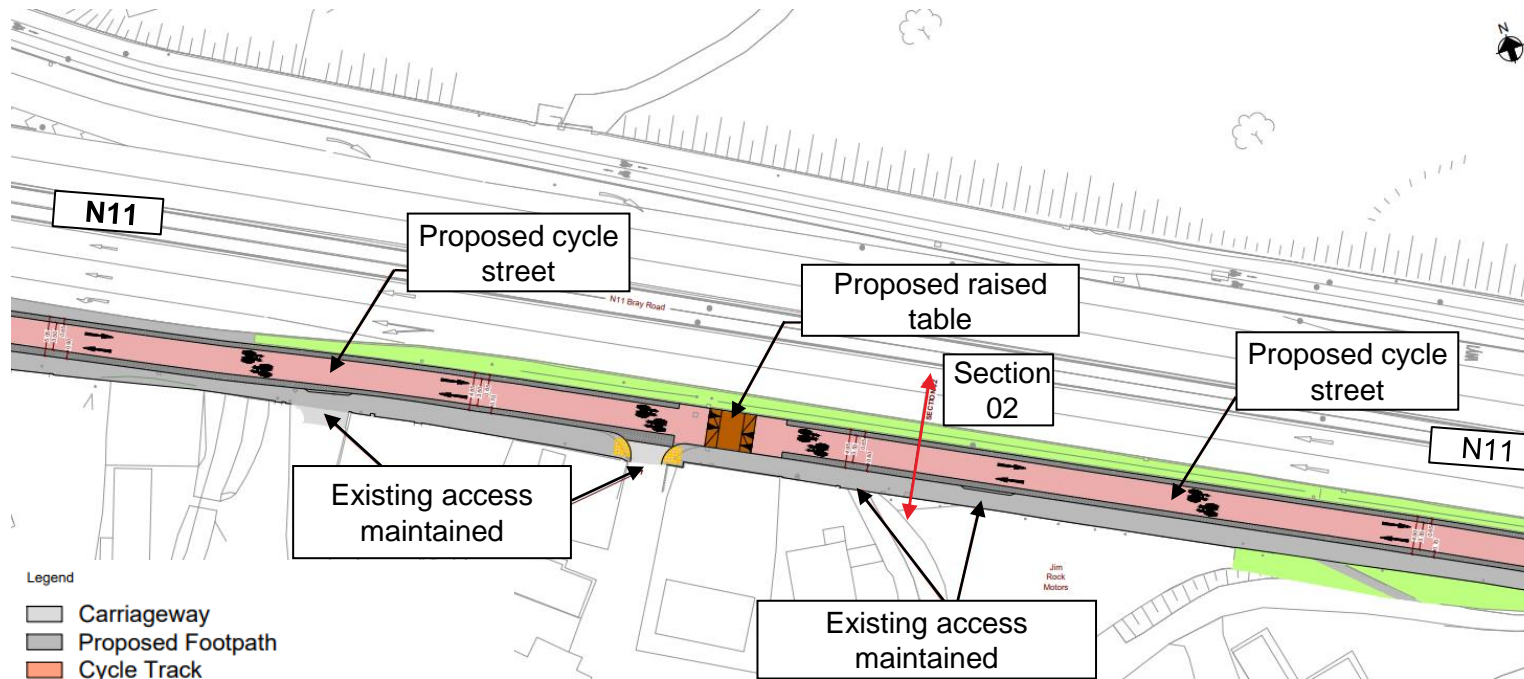

- Legend
- Carriageway
 - Proposed Footpath
 - Cycle Track
 - Shared Path
 - Raised Table
 - Grass Area/Verge
 - 'Cycle Street' (red coloured pavement)
 - 'Cycle Street' at-grade Textured Strip

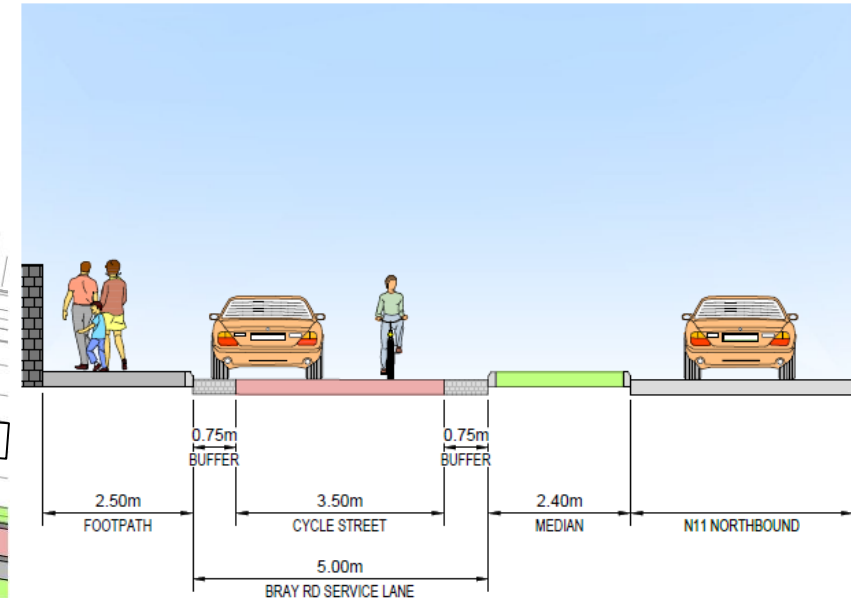

Cross Section 02

KEY FEATURES:

- 300m in length
- Cycle street
- Access maintained to existing properties

Section 3

Bray Road

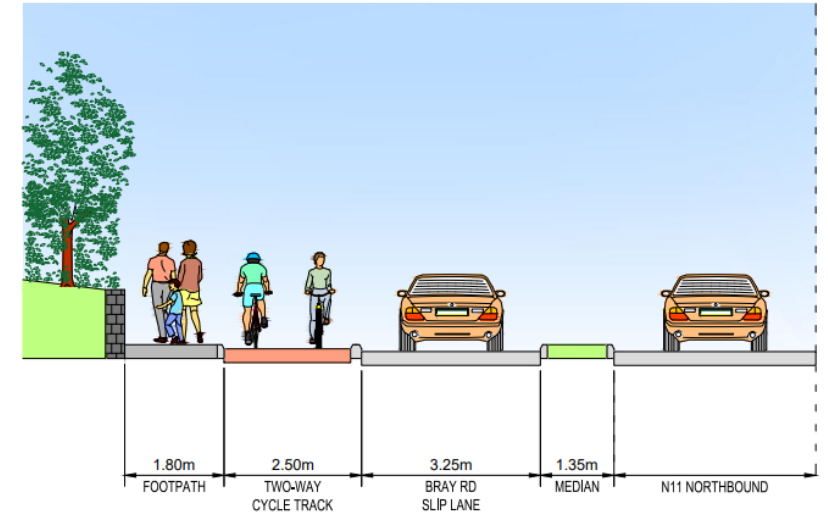
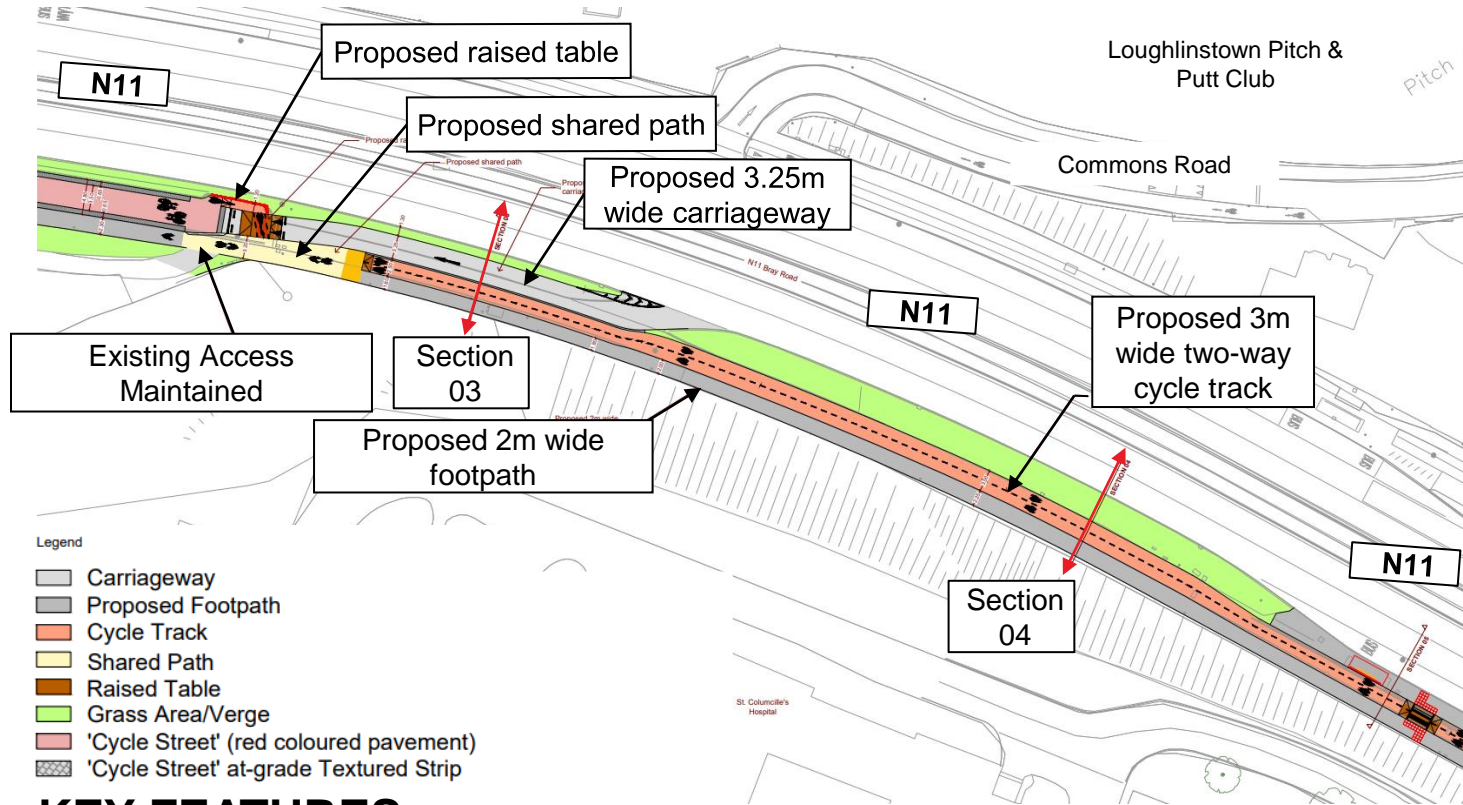

Cross Section 03
1:100

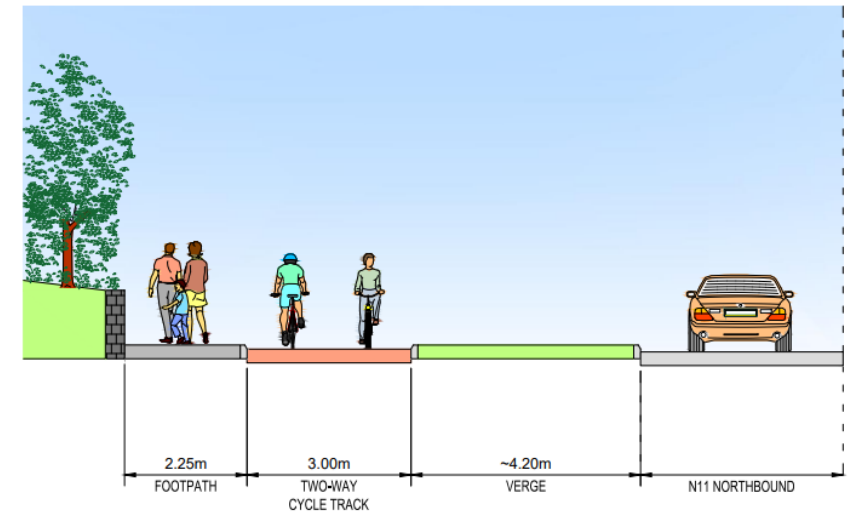

Cross Section 04
1:100

KEY FEATURES:

- 250m in length
- Cycle street transitions briefly into shared path at end of cycle street
- Shared path transitions into segregated two-way cycle lane and footpath
- Access maintained to existing properties

Section 4

Bray Road (southern section) to Rathmichael Manor

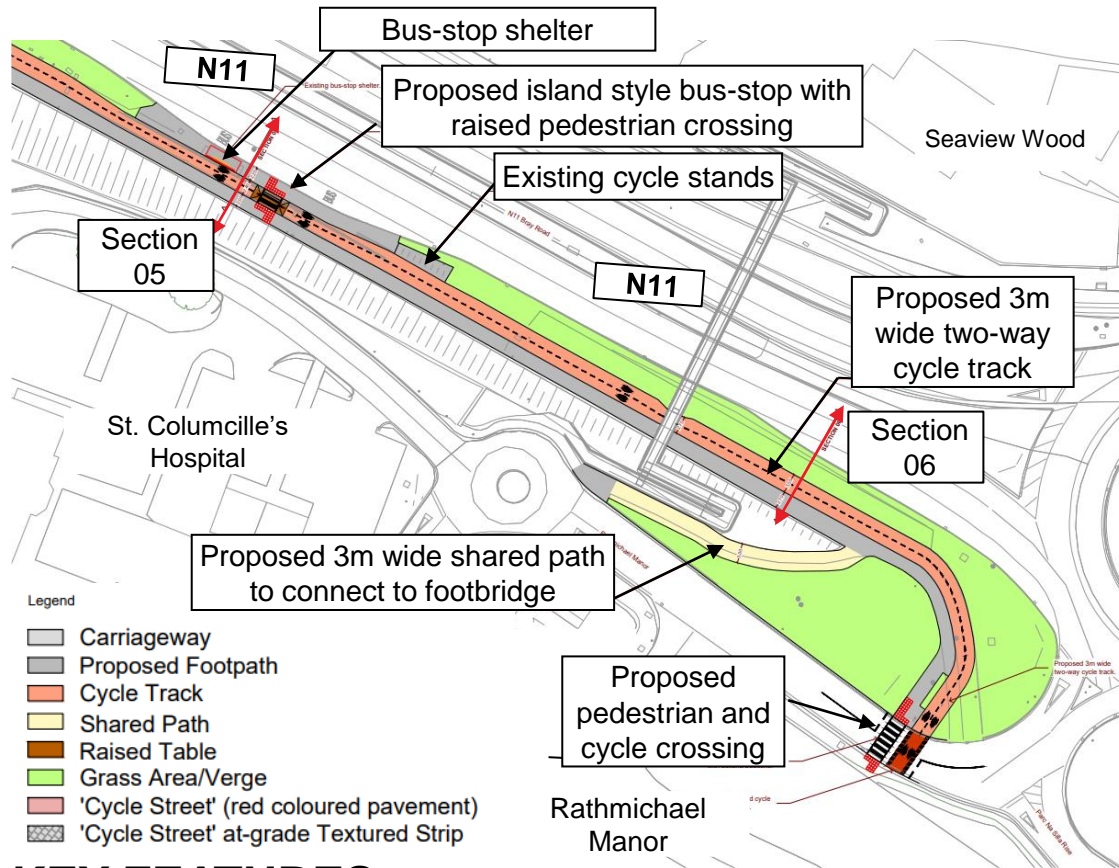

KEY FEATURES:

- Segregated two-way cycle lane and footpath
- 3m shared path to connect to footbridge to cross N11
- Modification to existing bus stop to an island style bus stop as well as pedestrian crossing of cycle lane

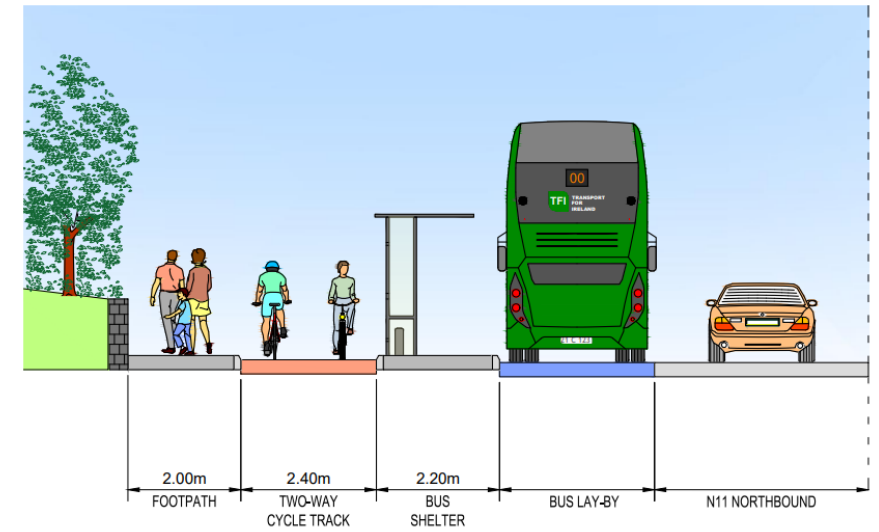

Cross Section 05

1:100

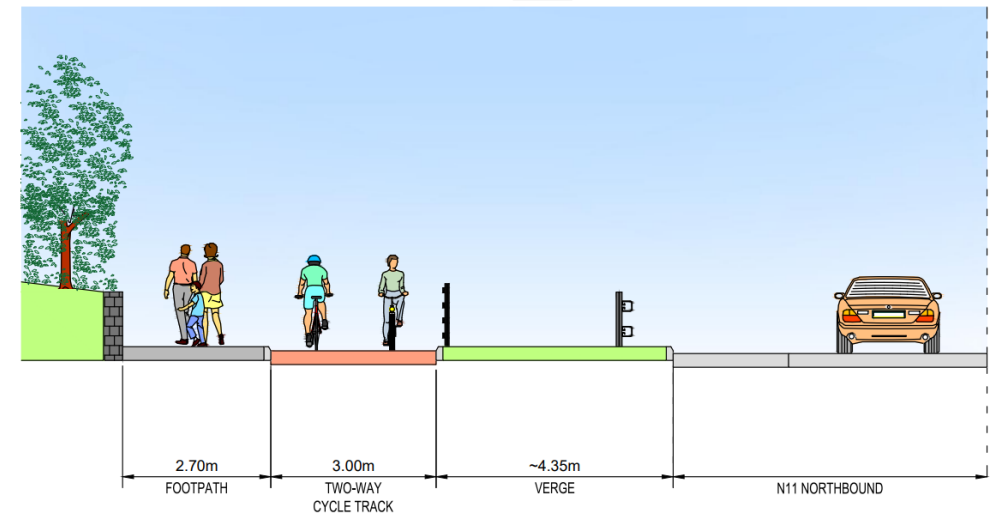

Cross Section 06

1:100

NEXT STEPS

- Section 38 of the Road Traffic Act 1994, non-statutory public consultation
- Detailed Design
- Tender and Contractor Procurement
- Construction Phase

For more information see DLRCC Consultation Hub Link:

<https://dlrcoco.citizenspace.com/>