

**LEGEND**

- Sign Location
- Approved Barrier System
- Traffic Cones
- Works Area Surrounded with Approved Barrier

- Note:
1. All signs to comply with Chapter 8 of the "Traffic Signs Manual"-Guidance Document.
  2. All Traffic Management to be carried out in accordance with Chapter 8 of the "Traffic Signs Manual".
  3. Detailed Risk Assessment to be carried out prior to the installation of Traffic Management System.
  4. The Contractor shall be responsible for providing all required ramp access to all changes in road surface level where traffic runs on a temporary surface and also for cycle/pedestrian ramps where footpath, cycle paths or any surface which has a level discontinuity as a result of the works.
  5. Exact sign positions to be agreed on site.
  6. All safety zones to be maintained at all times.
  7. All affected Parties to be notified prior to works commencing.
  8. All signs to be 600 X 600mm and faced with retro-reflective material to class ref 2 of EN 12899.
  9. "End of Roadworks" sign placed 20m to 50m from end of works area.
  10. Pedestrian boards to be used around works area if required.
  11. Temporary Walkway / Footpath to be kept at a minimum width of 1.2m at all times during the works.

### Pedestrian Management Layout for Pavement Cores through a Public Walkway at Seapoint

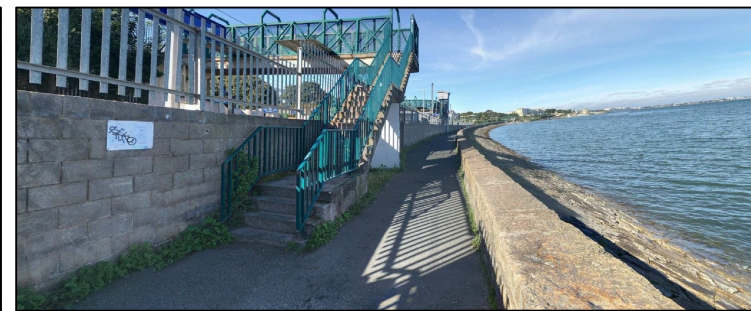
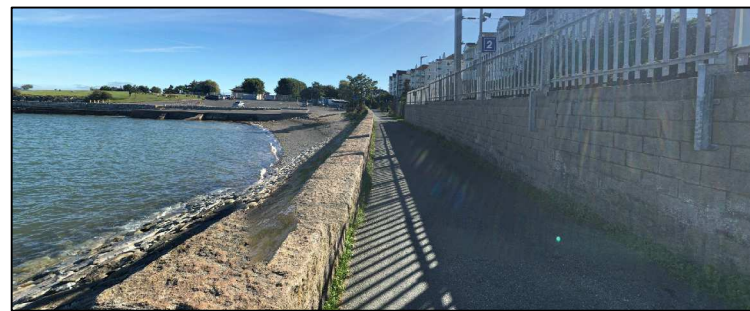
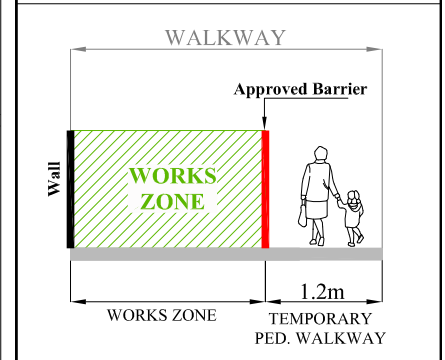
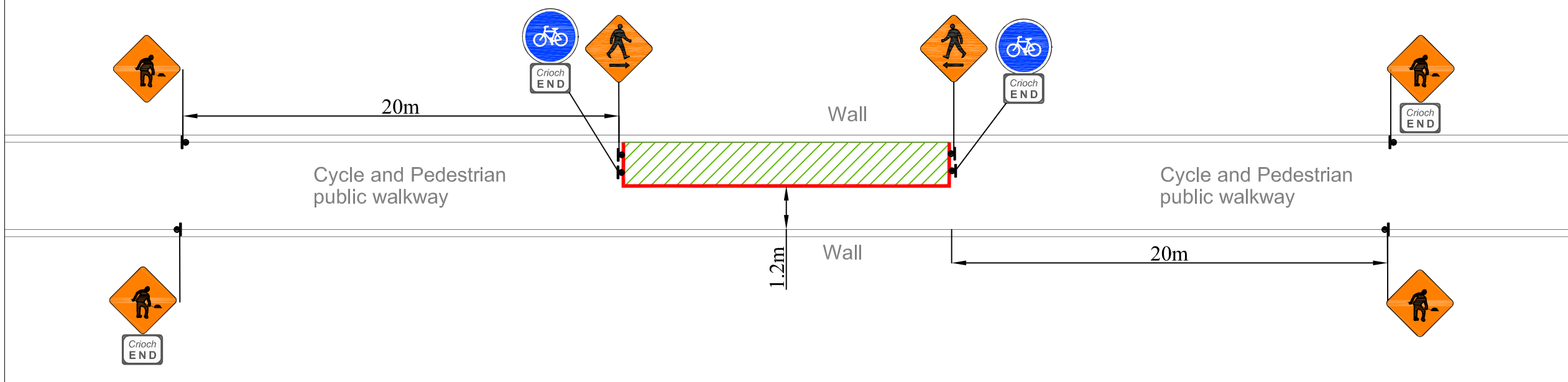

	Rev:	Description:	Date:	Job Details:	Drawing:	Dwg no:
				23-0731 ECRIPP Salthill, Seapoint Ave, Monkstown Dún Laoghaire, Blackrock, Co. Dublin	Pedestrian Management Layout for Pavement Cores through a Public Walkway	01
				Sheet:	CAD File ref.:	Rev:
					Drawn By: AK	Scale: As Shown
					Date: October 2024	